

ECO-DRIVE W 8

Screwed-in anchor with metal pin and telescopic design
support washer for mineral wool



Description

Universal screwed-in fastener for fastening of mineral wool

Type of insulation material with which the fastener is to be used



Mineral wool

ETAG 014 use cat.

A	B	C	D	E
Concrete	Solid clay bricks, Calcium silicate bricks	Porous blocks	Elements on LAC lightweight aggregate	Aerated concrete

Features and advantages of the product



Screwed-in anchor

Screw-driven fastener recommended for use in brittle materials to avoid damaging of the substrate with a hammer. Screw-driven nail guarantees achieving best strength parameters and facilitates flush fitting of the fastener with the insulation material. These fasteners are real time-savers



Modern telescopic design

Combination of telescopic design and a cutting washer offers a most advanced fastener on the market with covered up installation spot which eliminates the use of cutter and reduces pollution with polystyrene dust



Mineral wool disc

Fasteners come with mineral wool discs, which are used to complete the installation process by covering the fasteners. This eliminates thermal bridging and ensures good aesthetics of the outer layer



Pre-assembled fasteners

Screw-in parameters and provides for flush fitting of the fastener with the insulation material. These fasteners are real time-savers

ECO-DRIVE W 8

Screwed-in anchor with metal pin and telescopic design support washer for mineral wool

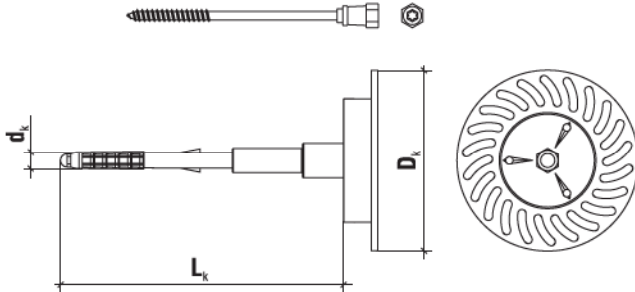

Product marking

ECODRIVE W	08	150	(50)
Fastener type	Diameter	Length	Number of pieces in a box

PRODUCT RANGE

	Code	$d_k \times L_k$ [mm]	Insulation material thickness t_{fix} [mm]			Pcs.
			New buildings		Old buildings	
			t_{tot} adhesive layer of 10 mm		t_{tot} adhesive layer of 10 mm + 20 mm of old plaster	
			Cat. A B C D	Cat. E	Cat. A B C D	
08	ECODRIVE-W-08150(50)	8x150	80	—	—	50
	ECODRIVE-W-08170(50)	8x170	100	80	80	50
	ECODRIVE-W-08190(50)	8x190	120	100	100	50
	ECODRIVE-W-08210(50)	8x210	140	120	120	50
	ECODRIVE-W-08230(50)	8x230	160	140	140	50
	ECODRIVE-W-08250(50)	8x250	180	160	160	50
	ECODRIVE-W-08270(50)	8x270	200	180	180	50
	ECODRIVE-W-08290(50)	8x290	220	200	200	50
	ECODRIVE-W-08310(50)	8x310	240	220	220	50
	ECODRIVE-W-08330(50)	8x330	260	240	240	50
	ECODRIVE-W-08350(50)	8x350	280	260	260	50
	ECODRIVE-W-08370(50)	8x370	300	280	280	50
	ECODRIVE-W-08390(50)	8x390	320	300	300	50
	ECODRIVE-W-08410(50)	8x410	340	320	320	50
	ECODRIVE-W-08430(50)	8x430	360	340	340	50

TECHNICAL DATA

Parameter	Unit	Value
Plug diameter	d_k [mm]	8
Washer diameter	D_k [mm]	110
Anchorage depth	h_{eff} [mm]	35/55*
Drilled hole depth	h_d [mm]	45/65*
Thermal conductivity	χ [W/K]	0.002
Washer stiffness	S [kN/mm]	0.60
Use categories	-	A B C D E
Plug material	-	PA
Pin material	-	Carbon steel, nylon + GF coated head
European Technical Approval	-	ETA-13/0107

* - ETAG 014, use category E (aerated concrete)

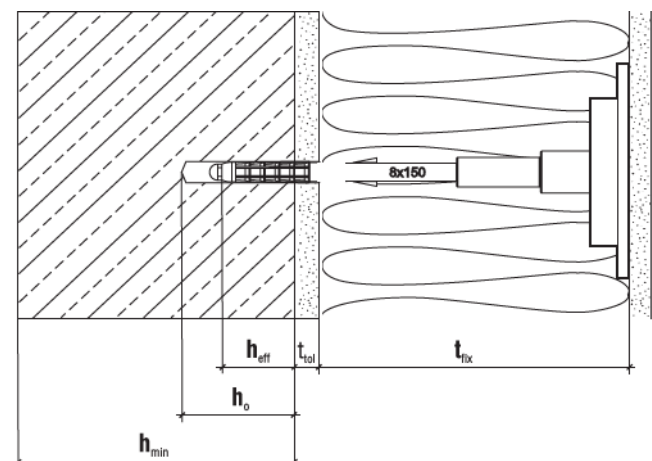

ECO-DRIVE W 8

Screwed-in anchor with metal pin and telescopic design support washer for mineral wool

RESISTANCE

ETAG 014 use cat.	Substrate	Density [kg/dm ³]	Characteristic pull-out resistance
A	Concrete C12/15	≥ 1.80	1.20
A	Concrete >C16/20	≥ 2.30	1.50
B	Solid clay bricks	≥ 2.00	1.50
B	Calcium silica solid brick	≥ 2.00	1.50
C	Calcium silicate hollow blocks	≥ 1.60	1.50
C	Perforated solid brick	≥ 1.20	1.50
C	Lightweight concrete hollow block HBL	≥ 0.80	1.50
D	Lightweight concrete blocks LAC	≥ 1.05	0.90
E	Autoclaved aerate concrete AAC2	≥ 0.35	0.60
E	Autoclaved aerate concrete AAC7	≥ 0.65	1.20

Partial safety factor for anchor resistance $\gamma_m=2$ (valid in absence of national regulations)

INSTALLATION DATA

Fastener type	ECO-DRIVE W 8
Min. base material thickness h_{min} [mm]	100
Minimum anchor spacing L_{cs} [mm]	100
Minimum edge distance C_{min} [mm]	100

Installation of a fastener with a mineral wool disc – installation spot covered up

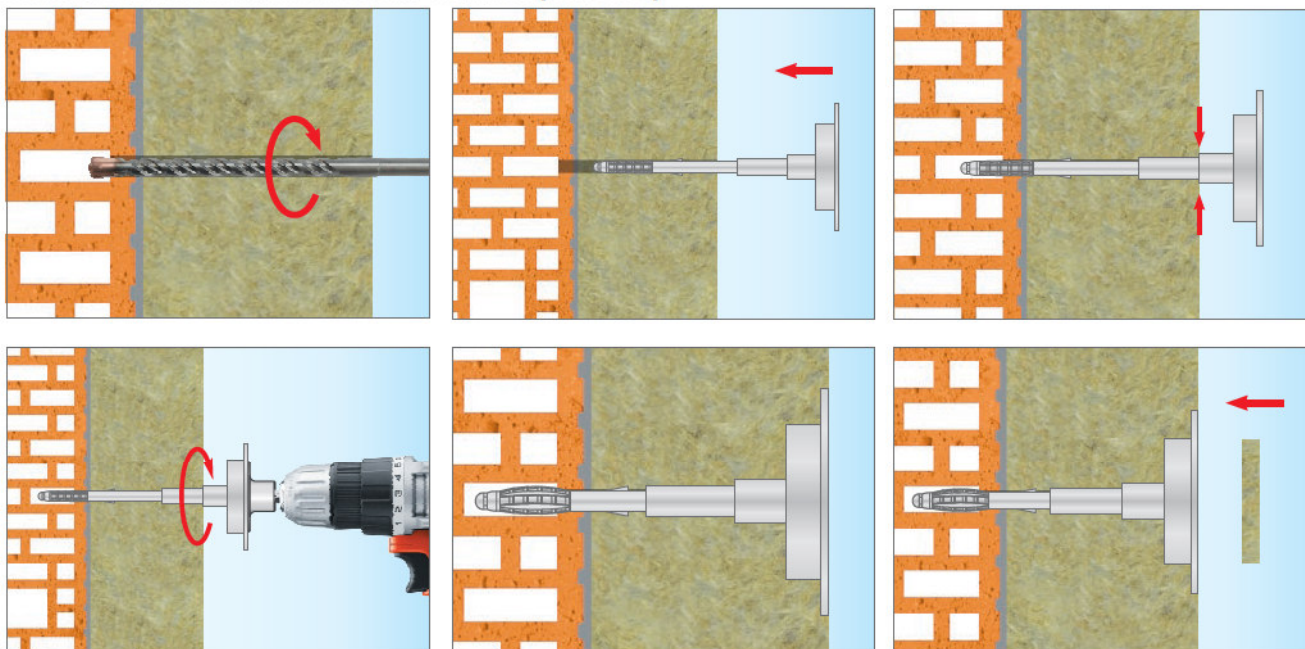

INSTALLATION ACCESSORIES

Setting tool (for ECO-DRIVE W)

EDST-W

diameter \varnothing 65 mm

Specifications:

- ECO-DRIVE W 8 i DRIVE W setting tool - see Table no. 3 page 22



Mineral wool disc (for ECO-DRIVE W)

EDKW

diameter \varnothing 67 mm

Specifications:

- Mineral wool disc density 135 kg/m³

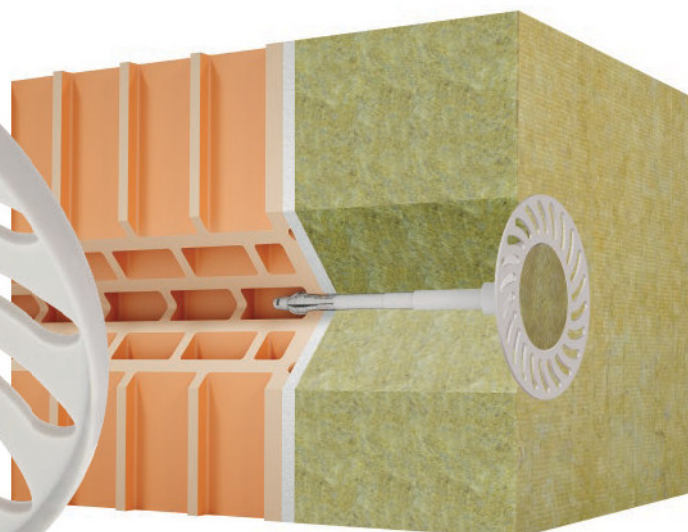

Special cutting edges
provide for flush fitting of the support washer with the surface of mineral wool layer

